

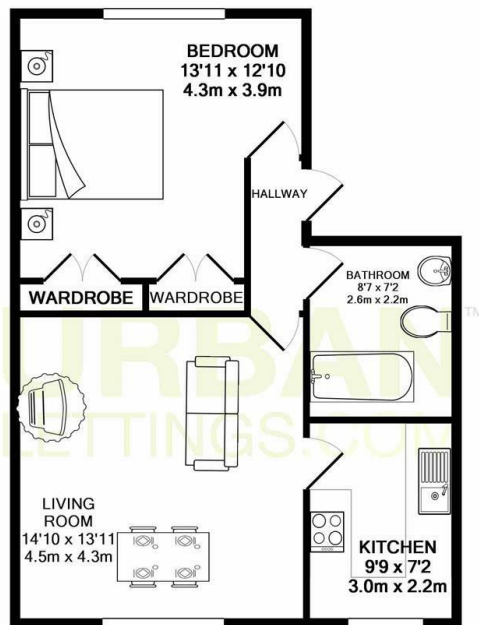

St James Terrace, SW12 8HJ

£1,900 Per Month

- Refurbished one double bedroom flat
- Separate fitted kitchen
- Neutral décor throughout
- Top floor of a well-maintained mansion block
- Modern bathroom
- Excellent transport links and local amenities nearby
- Spacious reception room
- Double bedroom with built-in wardrobes



TOTAL APPROX. FLOOR AREA 539 SQ.FT. (50.1 SQ.M.)

Whilst every attempt has been made to ensure the accuracy of the floor plan contained here, measurements of doors, windows, rooms and any other items are approximate and no responsibility is taken for any error, omission, or mis-statement. This plan is for illustrative purposes only and should be used as such by any prospective purchaser. The services, systems and appliances shown have not been tested and no guarantee as to their operability or efficiency can be given
Made with Metropix ©2017

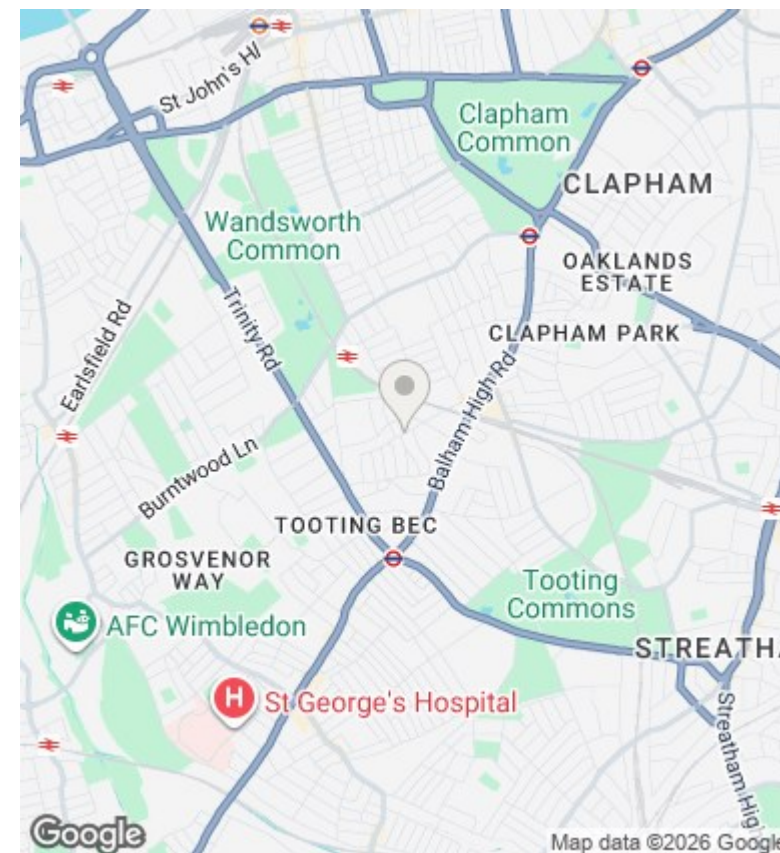

Directions

Viewings

Viewings by arrangement only. Call 020 7585 2761 to make an appointment.

Council Tax Band

C

EPC Rating:

D

| Energy Efficiency Rating | | |
|---|-------------------------|-----------|
| | Current | Potential |
| Very energy efficient - lower running costs | | |
| (92 plus) A | | |
| (81-91) B | | |
| (69-80) C | | |
| (55-68) D | 59 | 63 |
| (39-54) E | | |
| (21-38) F | | |
| (1-20) G | | |
| Not energy efficient - higher running costs | | |
| England & Wales | EU Directive 2002/91/EC | |